







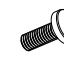

A	B	C	D	E	F	G
M6 x 25mm	M4 x 12mm	M4 x 16mm	M5 x 16mm	M6 x 16mm	M5 washer	M5 x 10mm
						
X3	X8	X8	X8	X8	X8	X4

- Read these instructions carefully before assembling your equipment.
- Check the equipment has been supplied with all parts and fixtures prior to assembly.
- Assemble in a suitable location.
- Two people will be required for assembly and three persons for the installation of the screen on to the equipment
- Do not attempt to alter or modify any part of the equipment or its attachments.
- Do not use if any parts are broken or appear to be damaged.
- Tighten all bolts and fixings securely with appropriately sized tools.
- Only use fixings provided with this equipment.
- Do not mount your TV close to sources of heat or moisture.

1

1A Secure upright and base together using fixing **A x3**

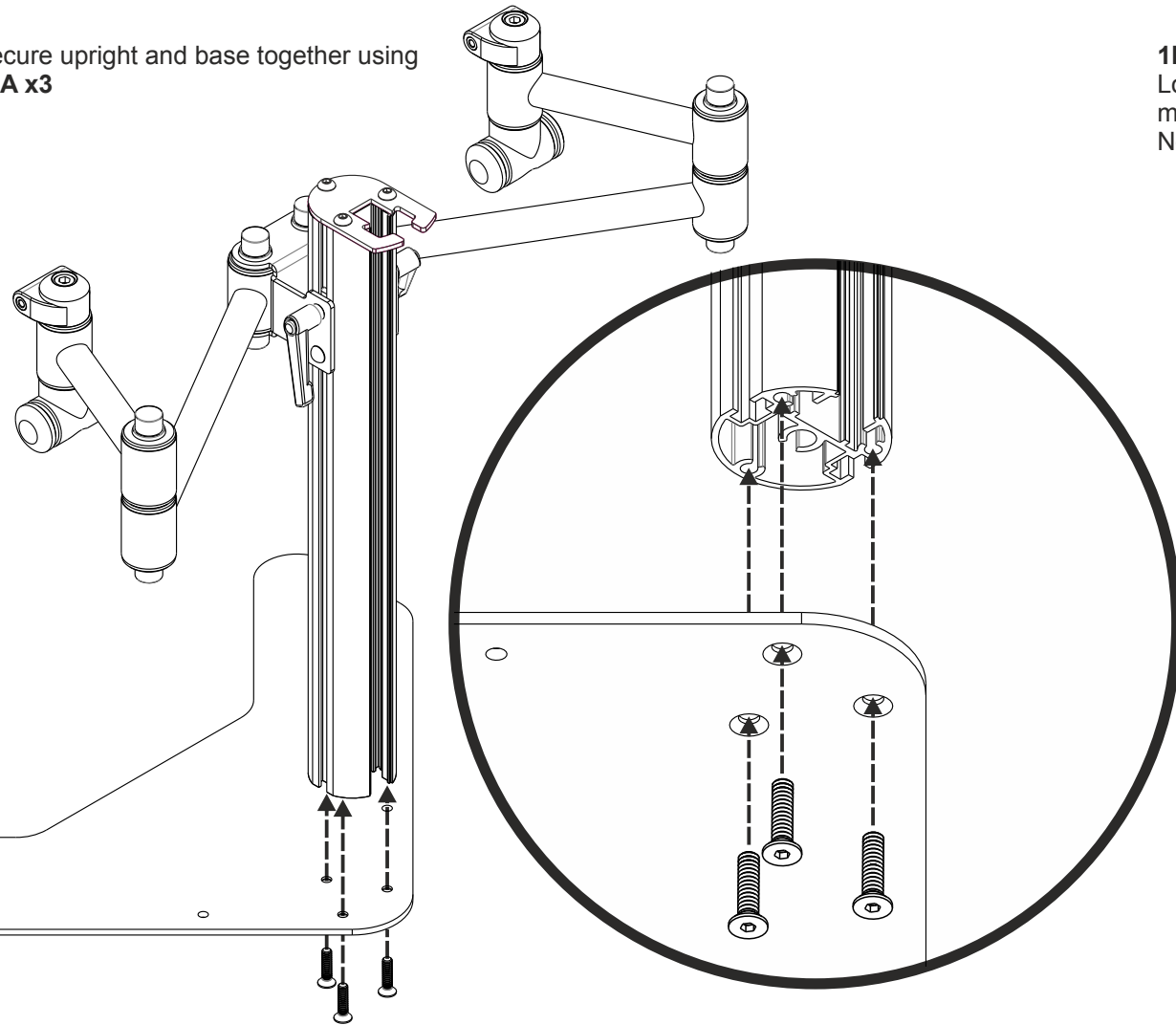

1B Set arms to a useable height
Loosen the ratchet handles on both sides, slide the mount to preferred height, re-tighten both ratchet handles.
Note: This can be also be adjusted after screens are installed.

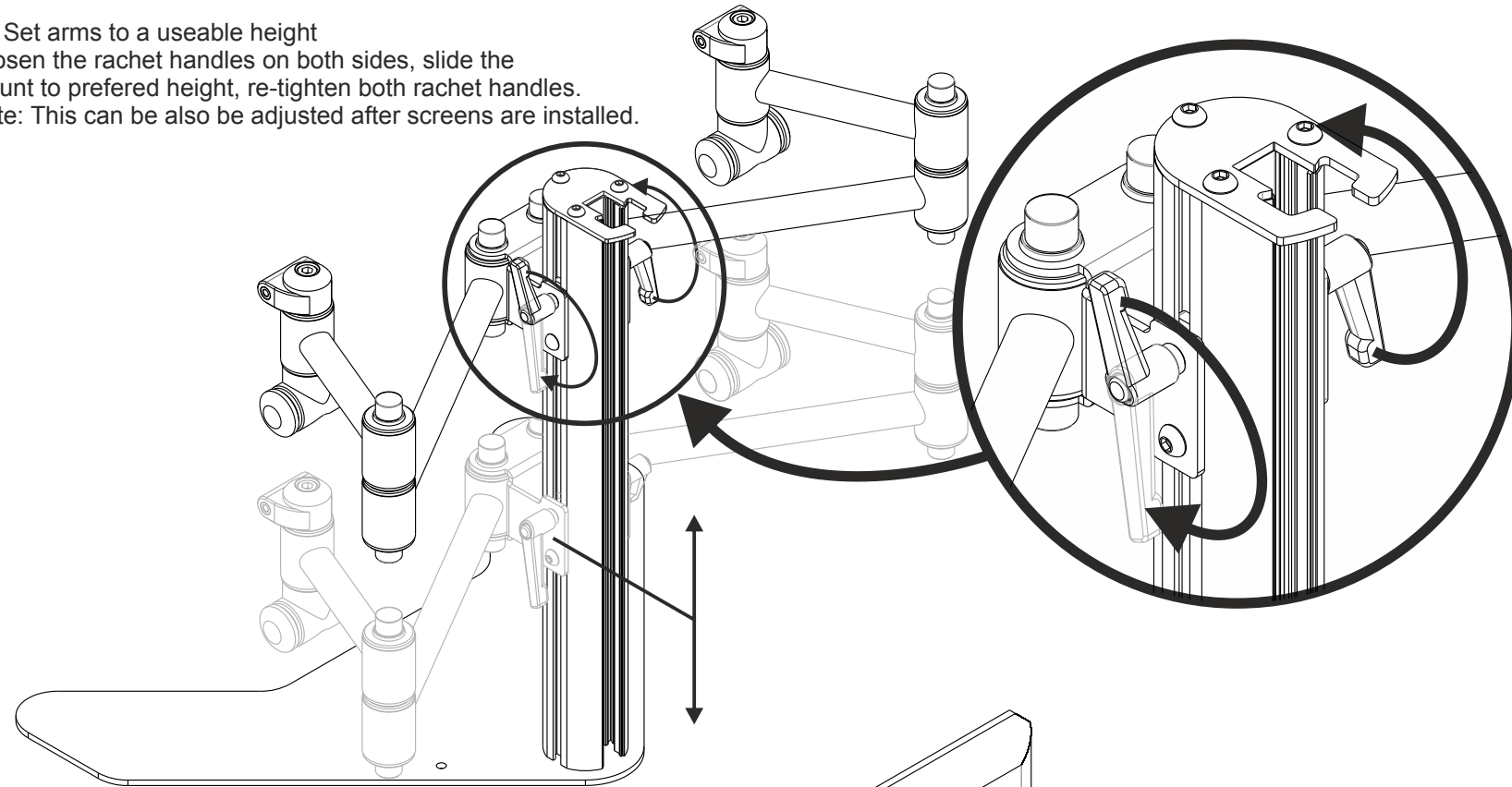

2

Attach TV interface mounts to each screen.
Note: Use same bolt pattern for attaching both screens.

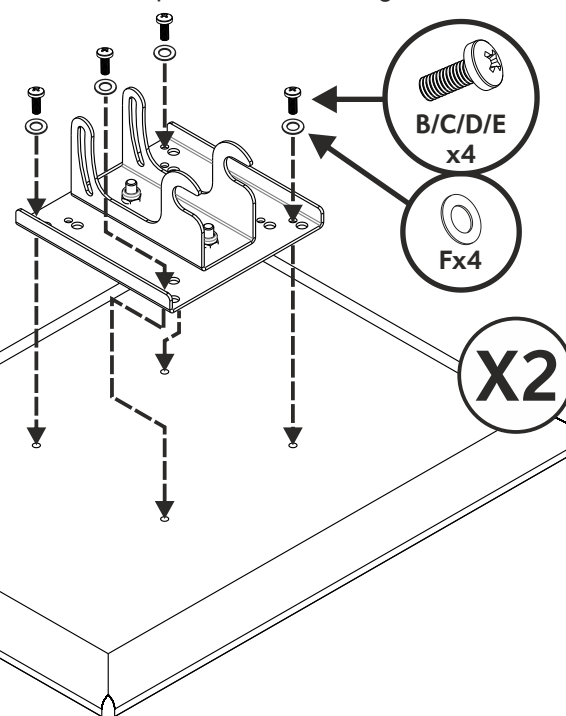

3

Mount screens on to stand
Note: An additional person should support the stand until both screens are secure
A - Locate hooks over the lower moulding and slide screen interface over the rest of the mount
B - Insert F x2 through the steel interface and in to the moulding to secure screen
Note: Loosen - adjust screen angle - tighten to achieve desired viewing angle

