

Mounting instructions for universal tilting TV wall bracket.

VESA 50/75/100/200

21" to 32" (53cm to 81cm) - Up to 25Kgs

Model No.
PMVMOUNT2053

Factory No.
Z0848T

Read these instructions carefully before installing your equipment.

Install the wall bracket in a suitable location using fixings which are appropriate for the wall material and structure. Consult a qualified builder if you're in any doubt as to the structural integrity of the wall.

Do not attempt to alter or modify any part of the wall mount or its attachments.

Do not use if any parts are broken or appear to be damaged.

Tighten all bolts and fixings securely. Only use fixings provided with this bracket.

Do not mount your TV close to sources of heat or moisture.

Always have a minimum of two persons to install the wall bracket and TV.

Fixing Kit



A - M4 x 16mm
B - M5 x 16mm
C - M6 x 16mm

x4



D - M4

x4



E - M5 x 16mm

x1

Also Required

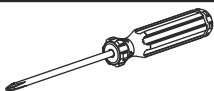

1 Mount Bracket To Wall

NOTE:

For ease of installation mount bracket on wall using position 1 and mark other positions using a spirit level. Then remove fixing from position 1, remove bracket and drill other positions.

Use Fixings suitable for your type of wall construction. (Not included).

Use All available fixing points.

If in any doubt of the suitability of the wall, it's construction or what type of fixings to use, consult a qualified builder or installer.

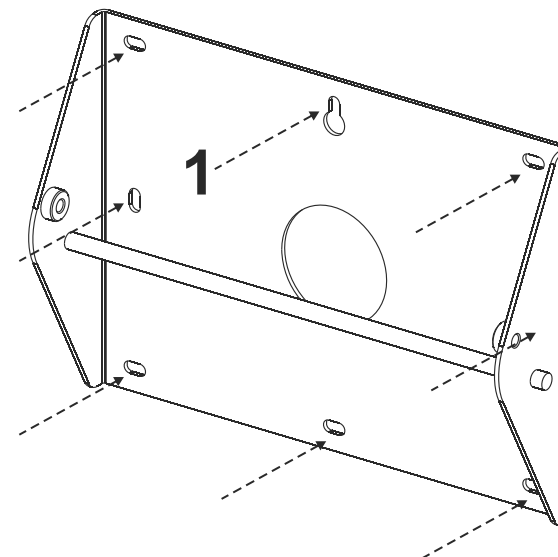

2 Attach Screen Fixing Plate To Screen

NOTE:

Washer only required when using M4 screw.



A-D x4

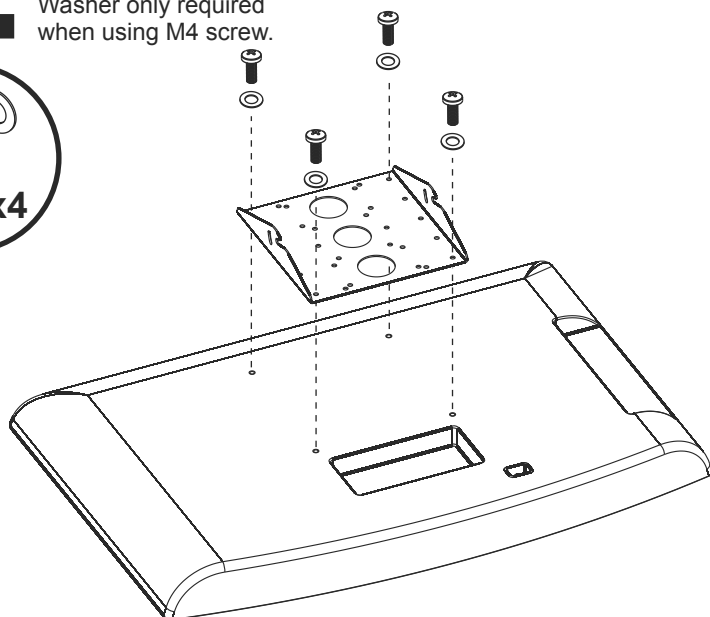

3 Hang Screen On TV Mounting Plate



Ex2

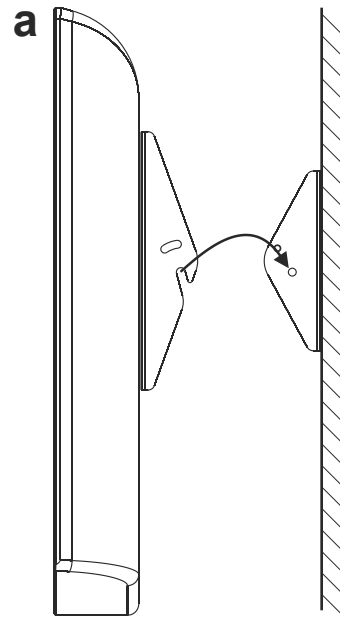

b NOTE:

To secure TV onto bracket insert screws 'E' as shown right (b). To adjust the tilt of the TV loosen these screws, adjust tilt to desired level and re-tighten screws.

