

Mounting instructions for Universal TV desk/table top stand.
VESA 200/300/400/600 x 400 - Universal up to 660mm X 400mm
32" to 52" (81cm to 132cm) - Up to 75Kgs

Model No.
PMVMOUNTMTD1

Factory No.
ZMTD1

- Read these instructions carefully before installing your equipment.
- Install the stand in a suitable location and only on a horizontal flat surface.
- Do not attempt to alter or modify any part of the desk mount or its attachments.
- Do not use if any parts are broken or appear to be damaged.
- Tighten all bolts and fixings securely. Only use fixings provided with this stand.
- Do not mount your TV close to sources of heat or moisture.
- Always have a minimum of two persons to install the TV.

Stand Assembly Kit

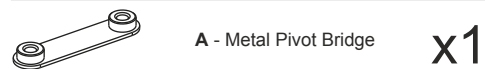

A - Metal Pivot Bridge **x1**



B - Metal Pivot Bush **x2**



C - Metal Pivot Washer **x2**



D - Nylon Pivot Spacer **x2**



E - Metal Pivot Axle **x1**



F - Nylon Pivot Pad **x1**

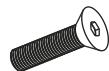

G - M8 x 35mm Bolt **x2**

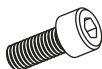

H - M8 x 20mm Bolt **x4**

TV Fixing Kit



I - M6 x 25mm **x4**



J - M8 x 16mm **x4**



L - M6 washer **x4**



N - M8 x 6mm **x4**

O - M8 x 12.5mm



P - M6 x 20mm **x2**

1 Assemble Stand

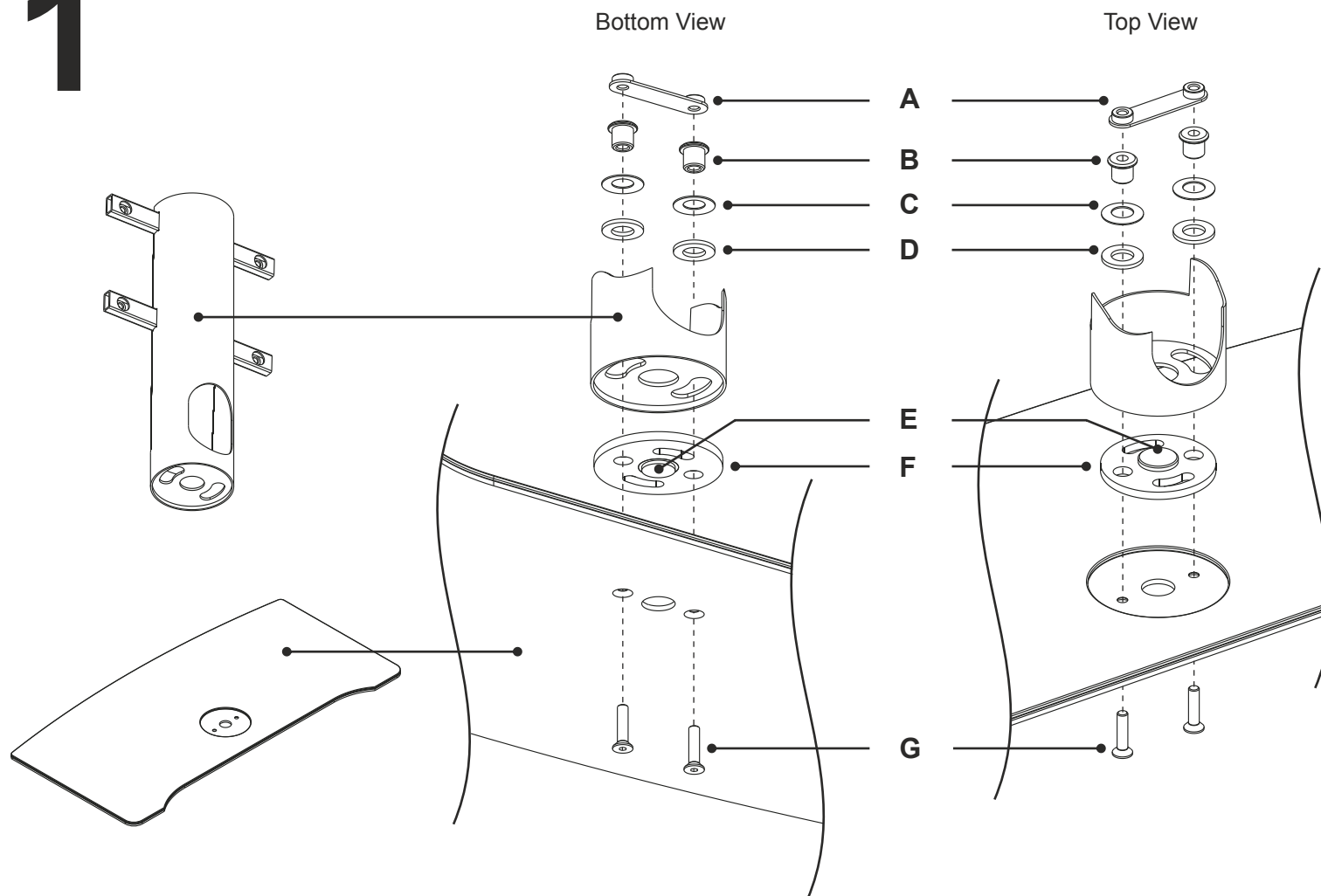

2

Attach TV Mounting Plate.

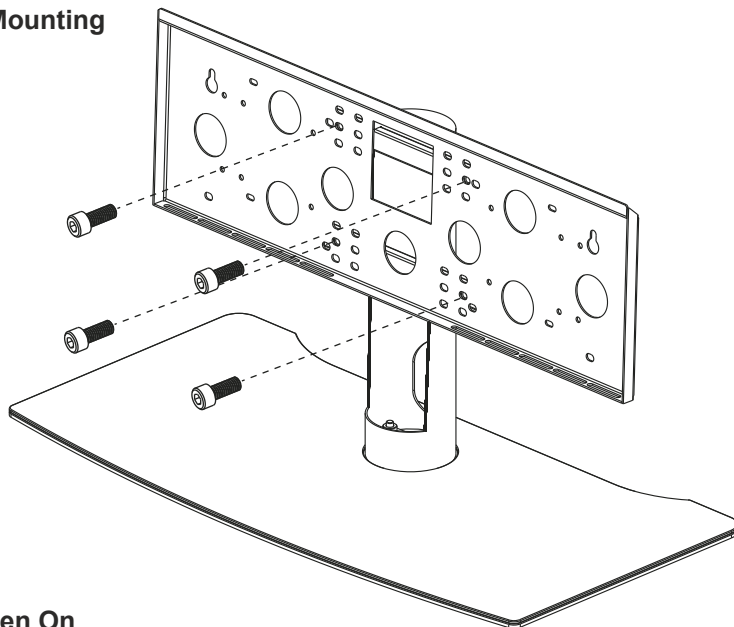

3

Attach Screen Fixing Uprights To Screen

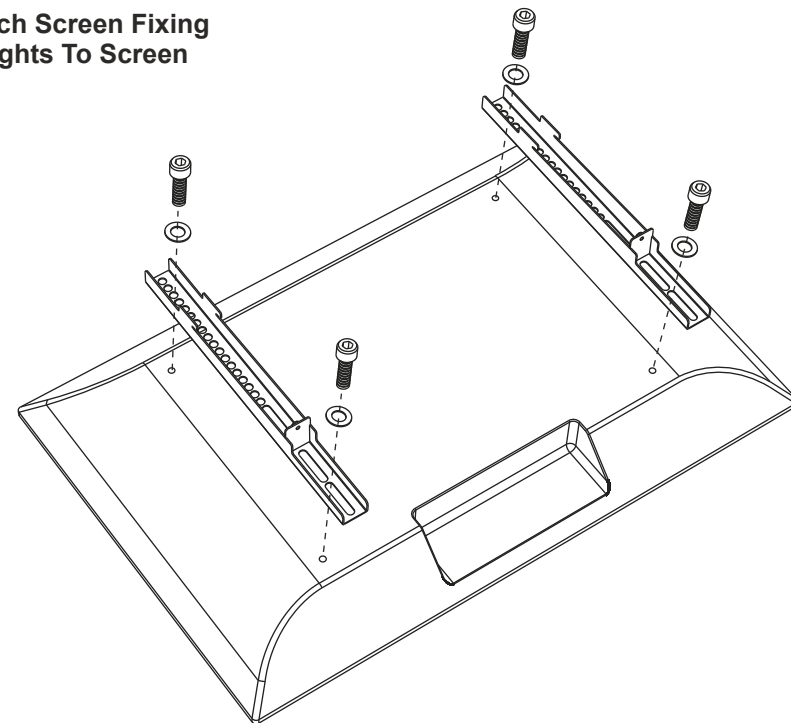
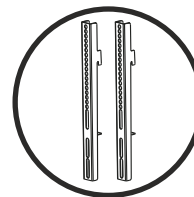

4

Hang Screen On TV Mounting Plate

