

Mounting instructions for universal 'Tilting & articulated TV wall bracket.

VESA 50 / 75 / 100 / 200 / 200x100 / 400x300

21" to 37" (53cm to 94cm) - Up to 30Kgs

Model No.

PMVMOUNTECH2058

Factory No.

Z0849

Read these instructions carefully before installing your equipment.

Install the wall bracket in a suitable location using fixings which are appropriate for the wall material and structure. Consult a qualified builder if you're in any doubt as to the structural integrity of the wall.

Do not attempt to alter or modify any part of the wall mount or its attachments.

Do not use if any parts are broken or appear to be damaged.

Tighten all bolts and fixings securely. Only use fixings provided with this bracket.

Do not mount your TV close to sources of heat or moisture.

Always have a minimum of two persons to install the wall bracket and TV.

TV Fixing Kit

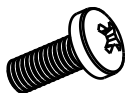

A - M4 x 16mm

B - M5 x 16mm

C - M6 x 16mm

X4



D - M4 Washer

X6



E - M5 Nut

X6



F - M5 x10

X6



G - M5 x 10mm (Pre-assembled)

X2

Also required

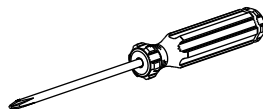

1 Mount Bracket To Wall

NOTE:

For ease of installation mount bracket on wall using position 1 and mark other positions using a spirit level. Then remove fixing from position 1, remove bracket and drill other positions.

Use Fixings suitable for your type of wall construction.

Use All available fixing points

If in any doubt of the suitability of the wall, its construction or what type of fixings to use, consult a qualified builder or installer.

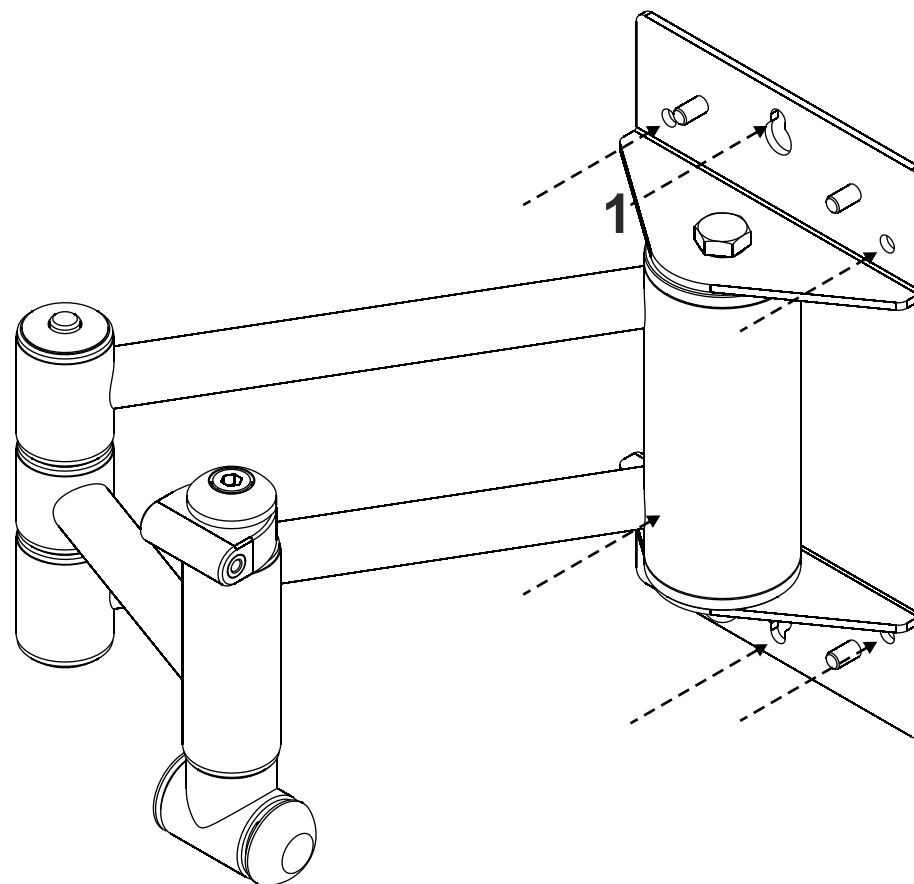

2

Attach Screen Fixing Plate To Screen



NOTE: Washer 'D' is only needed when using M4 bolt 'A'

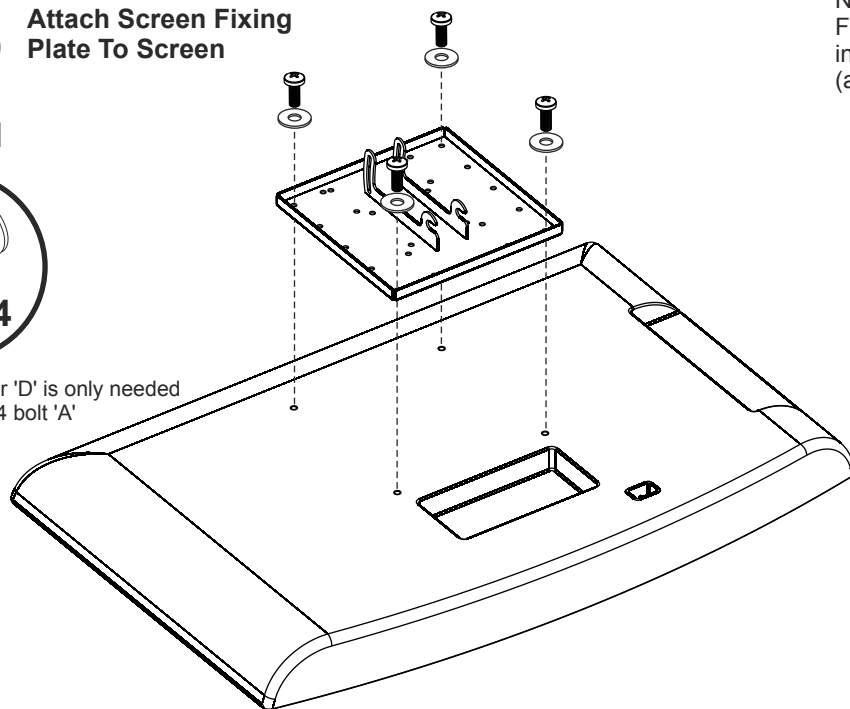

NOTE:

For TVs with fixing points larger than 200 x 200 (up to 400 x 300) use the extension arms provided in the box. Attach the extension plates to the TV plate with nuts 'E' and bolts 'F' as shown below (a). Then attach extension plates to TV as shown below (b).

a

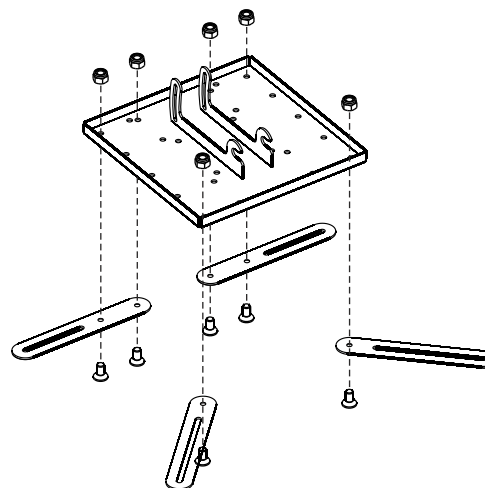

b

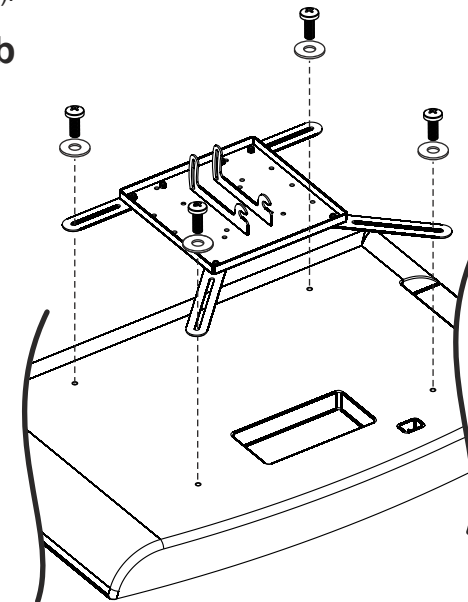

3

Hang Screen On TV Mounting Plate

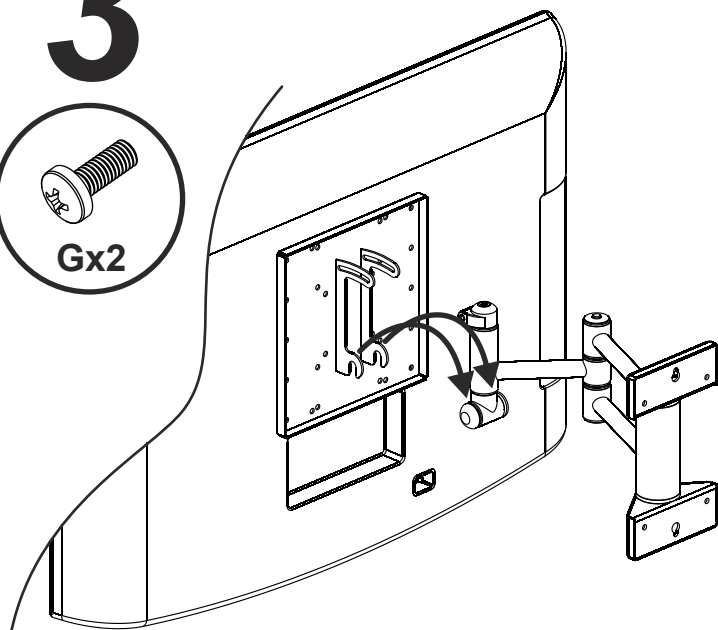

a

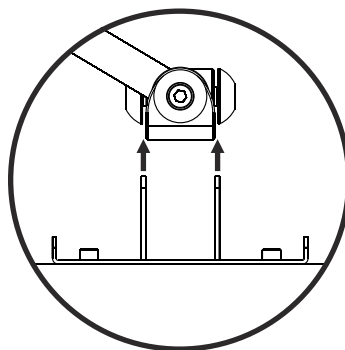

b

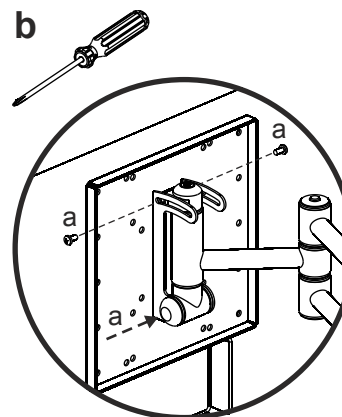

NOTE:

To secure TV onto bracket insert screws 'G' as shown above (a). To adjust the tilt of the TV loosen these screws, adjust tilt to desired level and re-tighten screws.

4

Attach Wall Plate Trims

